

Viking CCS pipeline Information sheet: Theddlethorpe facility

Introduction

As part of our additional consultation – running between 14 April and 14 May 2023 – we have invited feedback on a proposed option for the Theddlethorpe facility, west of the former gas terminal. This is one of two options for the location of the facility, with the other on the former gas terminal site (see Figure 1).

The Theddlethorpe facility is the above ground facility where the onshore pipeline would connect to the existing offshore pipeline (see Figure 2).

We have received several questions from local residents about the facility and this information sheet is intended to provide answers to the most common questions.

No decision has yet been made on a location. All of the comments we receive will help to inform this decision.

You can find out more about the pipeline project and how it will help put the Humber and Lincolnshire region at the forefront of carbon capture and storage technology at: consultation.vikingccs.co.uk

At the previous consultation, where was the information about the second option?

The two options for the Theddlethorpe facility were included within the Preliminary Environmental Information Report (PEIR) that we consulted on as part of the statutory consultation between 22 November 2022 and 24 January 2023. Details of the options were also included in the Non-Technical Summary (see the map on page 14 and description on page 17: consultation.vikingccs.co.uk/files/Viking-CCS-Volume-I-Non-Technical-Summary-NTS.pdf)

Some of our consultation materials, including the brochure and the information at our events, focused on our preferred option for the Theddlethorpe facility which is the location on the site of the former gas terminal (Option 1).

Why are you asking for comments on the option now?

During the previous consultation we received limited feedback on the Theddlethorpe facility, including its location at either location option. We have made some changes to the Draft Order Limits near to Option 2 (see Figure 1 overleaf) to accommodate the route of the pipeline and to facilitate access roads and an electrical connection. As we were consulting on revisions within the vicinity of Option 2, we are taking this opportunity to further highlight this option and invite feedback.

Figure 1: Map of the two options for the location of the Theddlethorpe facility

Revision: 1 Drawn: LC Checked: MK Approved: KP Date: 2023-04-28

Filename: \\eu.aecomnet.com\E\IA\UK\UK\NCL2\Jobs\6068955_V_Net_Zero_Project\900_CAD_GIS\920_GIS\02_Maps\Preliminary Drawings\CCS_P51_Theddlethorpe_Facility_v1_230428_LC.mxd

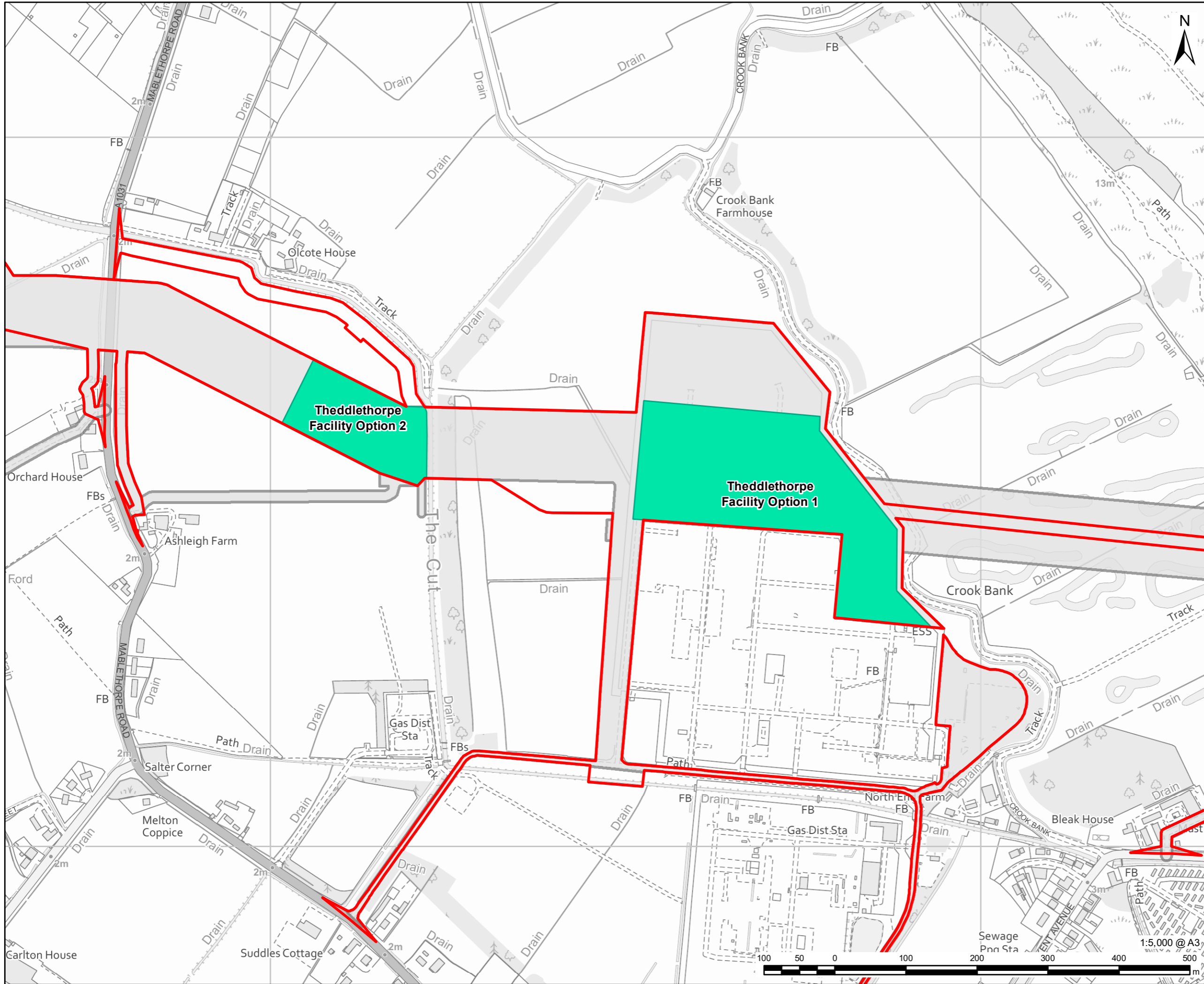

VikingCCS

AECOM

PROJECT
Viking CCS Pipeline

LEGEND

- Draft Order Limits - Current
- Draft Order Limits - Previous
- Reception Pipeline Facility

NOTES:
 Reproduced from Ordnance Survey digital map data © Crown copyright 2023. All rights reserved. Licence number 0100031673.

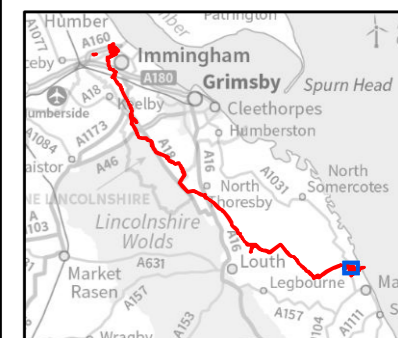

FIGURE TITLE
Theddlethorpe Facility

ISSUE PURPOSE
 FOR INFORMATION

PROJECT NUMBER / REFERENCE
 60668955 / VCCS_230428_P51

You can also view an interactive map of the proposals online at: consultation.vikingccs.co.uk/consultation/interactive-map

Why do you need the facility?

We need a facility at Theddlethorpe to connect the new onshore Viking CCS pipeline to the existing offshore LOGGS pipeline. The existing pipeline will allow captured carbon dioxide to be transported to the Viking offshore storage site under the North Sea.

What buildings and equipment will there be at the facility?

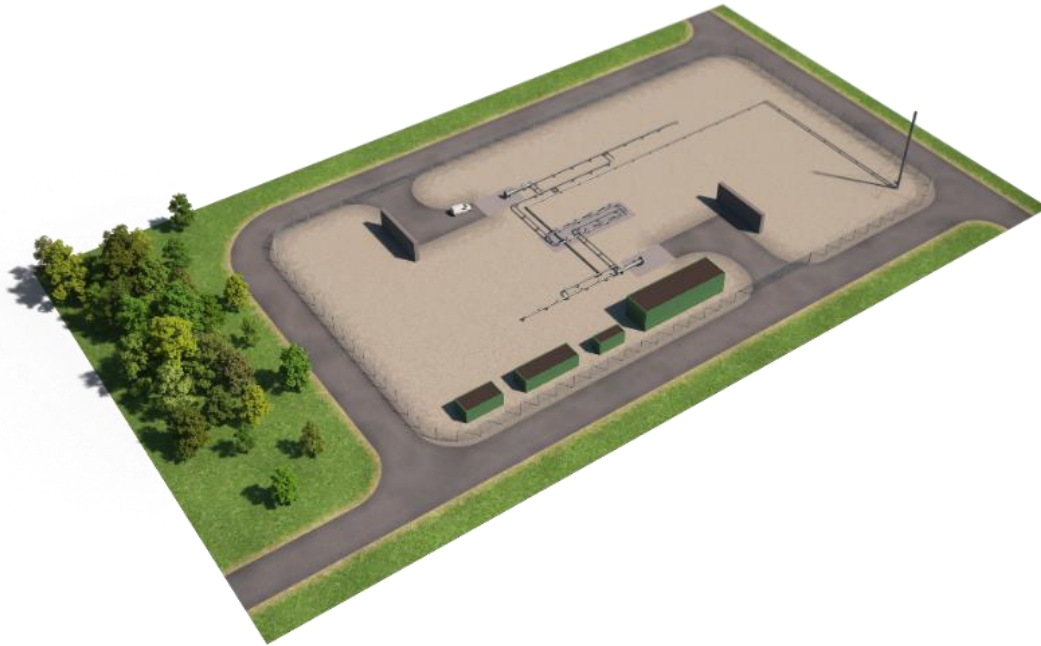

Figure 2: Indicative image of how the Theddlethorpe facility could look

The buildings and equipment would be the same at either location with a similar layout. Please see section 3.10 in Chapter 3 of the PEIR for a list of the features and buildings that would be part of the Theddlethorpe facility (available at: <https://consultation.vikingccs.co.uk/images/Viking-CCS-Chapter-3-The-Viking-CCS-Pipeline.pdf>).

At either location, the Theddlethorpe facility will be surrounded by security fencing and, if necessary, landscape planting will be used to further screen it. The facility will also have an access point from the road, an access track, and a gated access point.

What is the vent stack for?

It is required for venting off small quantities of CO₂ prior to periodic maintenance of the pipeline system (approximately every two years). Please see section 3.9 in Chapter 3 of the PEIR (linked above) for more information.

CO₂ is not a hydrocarbon and there will be no hydrocarbons in the pipeline. CO₂ is also not flammable and there will be no flaring from the vent.

Why have the access routes changed for the additional consultation?

How we access the site will depend on which option is chosen as the location for the Theddlethorpe facility. The access routes have been included to allow flexibility when choosing a location.

For Option 1, the access required to construct the Theddlethorpe facility would be via Mablethorpe Road to the south west of the former gas terminal. Access to the field west of the former gas terminal would only be required to install the new pipeline. In this case access would be gained where the pipeline crosses under Mablethorpe Road, with the southern access adjacent to Ashleigh Farm also temporarily being used.

For Option 2, to construct the Theddlethorpe facility a new access road would be installed along the northern edge of the field to the west of the former gas terminal. The access adjacent to Ashleigh Farm may also be temporarily used.

A Traffic Management Plan will be submitted as part of the DCO application, and this will include details about construction vehicle routes and safe access and egress points. This will be produced in consultation with the Local Highways Authorities and will aim to minimise disruption wherever possible.

How long will you need to use the facility at Theddlethorpe?

The pipeline is expected to be operational from 2027 and it will continue to be used throughout Harbour Energy's carbon capture and storage operations. The Viking offshore storage site has an initial carbon dioxide storage capacity of 300 million tonnes, which would take around 30 years to reach capacity.

How do your proposals for Theddlethorpe fit in with the Geological Disposal Facility?

For the option to locate the facility at the site of the former Theddlethorpe Gas Terminal, our intention is to only use some of the site to connect into the existing offshore pipeline. The wider terminal site will not be part of the project and is not owned by Harbour Energy. As the Viking CCS pipeline is a standalone project, we cannot comment on any other projects.

Our additional consultation is open until **Sunday 14 May 2023**

You can provide your views by

- Emailing us at: vikingccspipeline@aecom.com
- Writing to us at: **Freeport VIKING CCS PIPELINE** (no stamp needed)

If you have any questions, you can send them to our team using the details above or by phoning **07917 986 094**